

3M Occupational Health & Environmental Safety  
Supplied Air Respirators



# Breathing under the toughest conditions



## Benefits of the Modular Approach from 3M

3M have developed a comprehensive approach to worker protection systems based on comfortable-to-wear modules. Each system incorporates easy-to-select modules that can be combined into dozens of system configurations. All 3M™ Headtops and Air Delivery Units are compatible with one another. Users can mix and match modules as they move from one environment to another, or from one application to the next. This provides plug-and-play adaptability for the continually evolving demands of your workplace.

## Airfed Respirators by 3M

The modular range of 3M Airfed Respirators lets you choose how you want your system built, with the flexibility to change it in the future.

3M Airfed Respirators offer protection against dusts, mists, fumes, gases or vapours and combination hazards e.g. paint spray.

3M Airfed Respirators do not offer protection in confined spaces, oxygen deficient atmospheres or for asbestos stripping.

## Six stage selection process

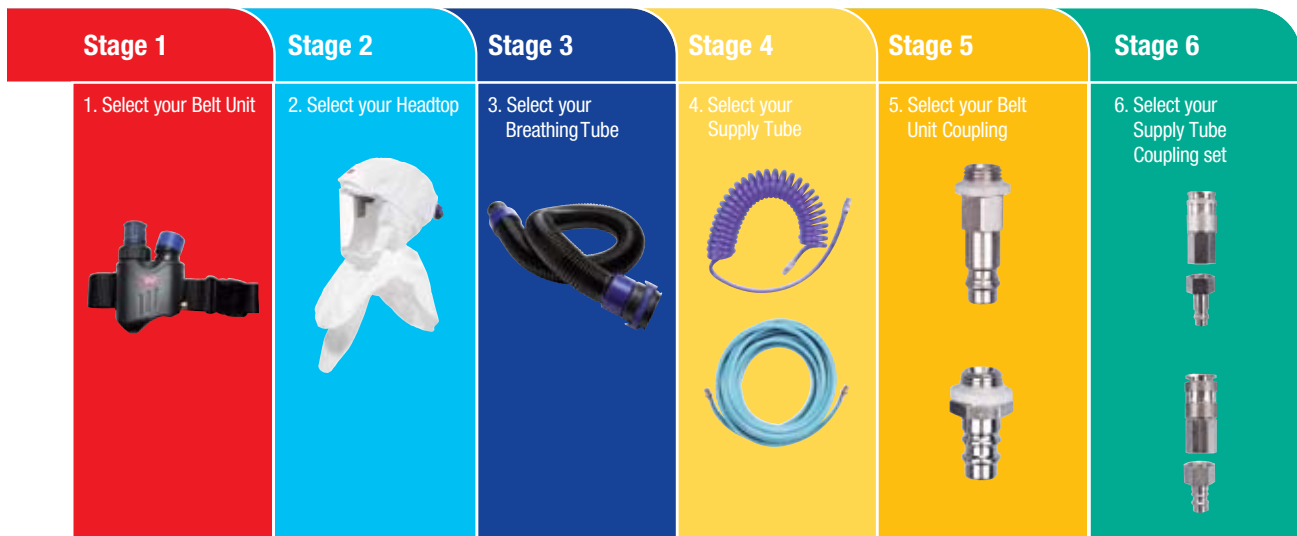

### Stage 1 - 3M™ Modular Belt Unit

#### 3M™ Flowstream Regulator

Balanced regulator specifically designed for respirator use. Ensures smooth airflow, optimum safety and comfort.

- Low-pressure warning whistle
- Replaceable charcoal filter
- Easy airflow adjustment
- Spray gun or compressed air tool port
- Approved to EN1835 with all featured headtops
- CE Marked
- APF = 20 with each headtop (APF = 40 with all Soft Headtops)



## Stage 2 - 3M™ Headtops

### Soft Headtops - Lightweight protection

Choose between the integrated suspension head covers – fully assembled and ready to use straight out of the box and the premium maintainable hoods. The integrated suspension head covers are available in two adjustable sizes to provide a comfortable fit for wearers: S/M and M/L.

The 3M™ Premium Maintainable Hoods (S-655, S-657, S-757 & S-855E) can be a highly cost-effective choice for some high disposal rate environments: just the soiled hood fabric is replaced, while the suspension and air ducting can be reused.

- Respiratory protection
- Coverage for head, face, neck and shoulders
- Eye protection to EN166 (F) low energy impact

### 3M™ Integrated Suspension Head Covers

S-133



S-333G



S-433



S-533



### 3M™ Premium Maintainable Hoods

S-655



S-657



S-757



S-855E



### 3M™ Visors

HT-401



HT-402



### Visors - Impact protection

- Respiratory protection
- Face and Eye protection
- Acetate (HT-401) – EN166 2 : F : 3 (low energy impact)
- Polycarbonate (HT-402) – EN166 2 : B : 3 : 9 (medium energy impact)

### 3M™ Welding Headtops

HT-629  
EN166 2:B/EN169



HT-639  
EN166 1:B/EN169



HT-749  
EN166 2 :B/EN169 / EN397



Speedglas Headtop



### Welding Headtops -

Welding applications and impact protection

- Respiratory protection
- Face and Eye protection
- Head protection (HT-749)

### 3M™ Bump Cap and Helmets

HT-701/707



HT-820



HT-840



HT-880



### Bump Cap and Helmets -

Head protection

- Respiratory protection
- Head, Face and Eye protection
- EN397 Approved (except HT-820)
- EN812 (HT-820)

## Stage 3 - 3M™ Breathing Tubes

- Connects the headtop to the regulator
- Simple click-in connection and independent swivel movement

BT-20



Lightweight



Rubber



Tube for S-Series only.  
Short and long available.

## Stage 4 - 3M™ Compressed Air Supply Tubes (CASTs)

Choose from 4 lengths

- Both ends of 3M™ CASTs have a 3/8" BSP male thread
- 3M CASTs form an integral part of the system approval process.

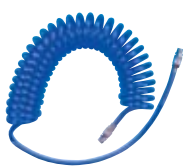

7.5m COILED CAST



10m CAST



30m CAST



10m CAST Antistatic

## Stage 5 - 3M™ Belt Unit Couplings

Choose from Rectus or CEJN plugs

- 1/4" BSP male thread



Rectus



CEJN

## Stage 6 - 3M™ Cast Couplings

Choose from Rectus or CEJN plug and socket sets

- 3/8" BSP female thread



Cast Connector



Rectus



Rectus



CEJN



CEJN

### 3M™ Visionair™ 500HV Respirator



Includes loose-fitting visor (similar to 3M™ HT-401 Visor), narrow-bore breathing tube and regulator

- Requires belt unit coupling (see stage 5) and CAST (see stage 6)
- Approved to EN270
- CE Marked
- APF = 40
- Y-piece to allow HVLP spray gun connection
- Typical applications – Paint spraying

### 3M™ S-200™ Respirator



Includes twin bayonet breathing tube to connect to any 3M bayonet facepiece (3M 6000 or 3M 7000 or 3M 7500 half or full face pieces). Regulator includes a CEJN coupling

- Requires S-200 CAST C-251, C-252 or C-253 (10, 20 or 30m)
- Approved to EN139
- APF = 20 with half mask
- APF = 40 with full face mask

### 3M™ Aircare Filter Unit



Filtration unit designed to filter compressed air supplied to the 3M range of Airfired Respirators

- Removes oil mist, particulate, water and nuisance level organic vapours
- If you intend to use the Aircare with the airfired CAST range (stage 4), it is advised to purchase another set of CAST couplings (see stage 6)
- Available wall or floor mounted



#### Occupational Health & Environmental Safety Group 3M United Kingdom plc

3M Centre  
Cain Road, Bracknell  
Berkshire RG12 8HT  
Tel: 0870 60 800 60  
www.3M.co.uk/worldofcomfort  
www.3M.co.uk/ohes

#### 3M Ireland Limited

The Iveagh Building  
The Park  
Carrickmines  
Dublin 18  
Tel: 1 800 320 500

Please recycle. Printed in UK.  
© 3M 2010. All rights reserved.

Did you know that 3M  
can test the quality of  
your breathing air?

Call us for more  
information.